

THE INFORMATION CONTAINED IN THIS DRAWING IS THE SOLE PROPERTY OF ANDERSON POWER PRODUCTS. ANY REPRODUCTION IN PART OR WHOLE WITHOUT THE WRITTEN PERMISSION OF ANDERSON POWER PRODUCTS IS PROHIBITED.

**Copyright 2013**

ANDERSON POWER PRODUCTS RESERVES THE RIGHT TO ALTER PRODUCT TYPES, THEIR TECHNICAL DATA, DIMENSION, STYLE AND ACCESSORIES WITHOUT PRIOR NOTIFICATION.

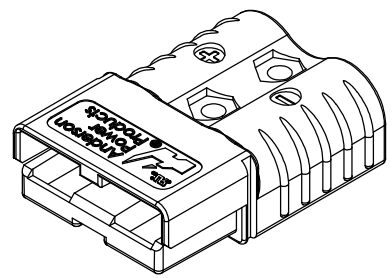
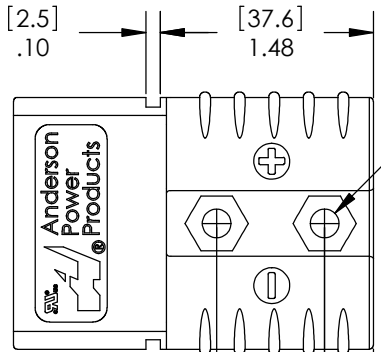

COLOR	P/N	MAT'L
GRAY	6810G1	PC
	P6810G1	PC/PBT
BLUE	6810G2	PC
	P6810G2	PC/PBT
RED	6810G3	PC
	P6810G3	PC/PBT

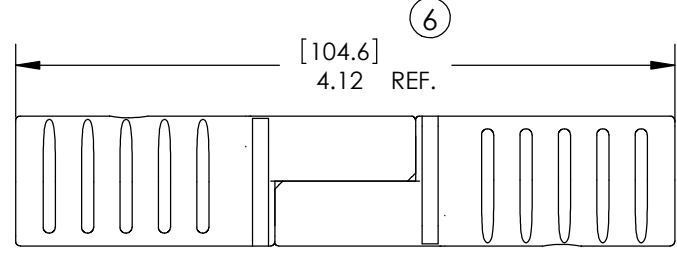
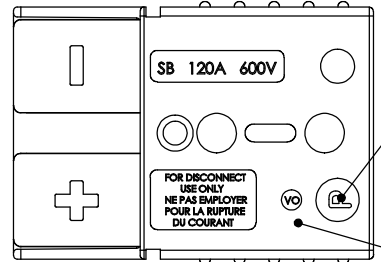
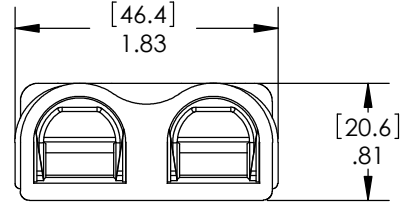
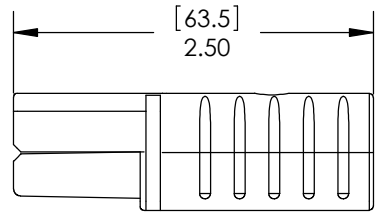
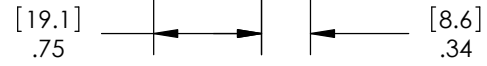

**MATED PAIR**

(6) DENOTES PBT MATERIAL

SEE NOTE 5 (5)

NOTES:

1. SPRING/HOUSING ASSEMBLIES ARE UL RECOGNIZED PER FILE E26226, CSA CERTIFIED PER LR25154
2. HOUSINGS ARE KEYPED TO ONLY ALLOW MATING WITH THE SAME COLOR HOUSING.
3. FOR ASSEMBLY INSTRUCTIONS, SEE DOCUMENT 1S1030A
4. HOUSING ASSEMBLIES ACCOMMODATE ANDERSON CONTACTS FOR WIRE RANGES #6 AWG TO #2 AWG.
5. MANUFACTURING AND AGENCY MARKINGS SHOWN ON THIS SURFACE. (6)

REV.	DESCRIPTION	APPRV	DATE
6	ECN 2016-0112 - CHANGED NOTE 7, ADDED REF. TO DIM.	CPD	12/9/2016
5	ECN 2016-0085	CPD	10/20/2016
4	ECRN-14934 COLOR KEYING ADDED	TWE	7/5/11
3	ECRN 14661: "PC/PBT" WAS "PBT"	CMS	7/7/10
2	ECRN 14391: REDRAW, UPDATE BORDER, ADD TABLE	AMS	3/3/09

REVISIONS

DIMENSIONS ARE IN:	INCH [MM]	APPROVALS	
UNLESS OTHERWISE STATED		DRAWN	BAL 10/24/2000
TOLERANCES:		CHECKED	DJD 10/24/2000
DECIMALS (INCH) .XX ± .02	DECIMALS (MM) .X ± .5	MFG APPRV	CHB 10/24/2000
ANGLES ±2°		QC APPRV	RPO 10/24/2000
SURFACE FINISH:		ENG APPRV	BAL 10/24/2000
MACHINED 128µin [3.2µ]			
MOLDED 64µin [1.6µ]			
MATERIAL: SPRINGS-STAINLESS STEEL			
HOUSINGS-SEE TABLE			
FINISH:			

**ANDERSON POWER PRODUCTS**

**TITLE**

**120A DUAL POLE SPRING AND HOUSING**

**SIZE A** **DWG NO. 114283S1** **REV. 6**

3rd ANGLE PROJECTION

-CAD GENERATED DRAWING- DO NOT MANUALLY UPDATE DO NOT SCALE

SCALE	CADFILE	SHEET
NONE	01310	1 OF 2

THE INFORMATION CONTAINED IN THIS DRAWING IS THE SOLE PROPERTY OF ANDERSON POWER PRODUCTS. ANY REPRODUCTION IN PART OR WHOLE WITHOUT THE WRITTEN PERMISSION OF ANDERSON POWER PRODUCTS IS PROHIBITED.

**Copyright 2013**

ANDERSON POWER PRODUCTS RESERVES THE RIGHT TO ALTER PRODUCT TYPES, THEIR TECHNICAL DATA, DIMENSION, STYLE AND ACCESSORIES WITHOUT PRIOR NOTIFICATION.

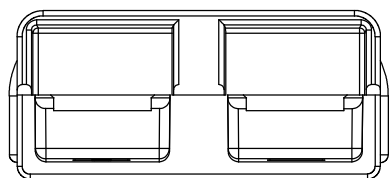

**GRAY VOLTAGE KEYING**

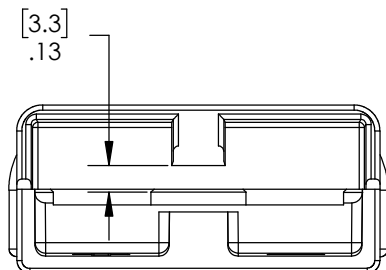

**BLUE VOLTAGE KEYING**

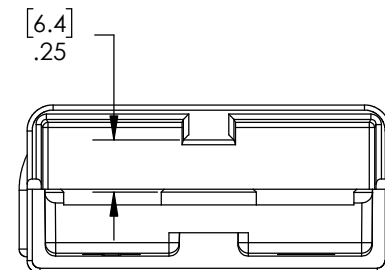

**RED VOLTAGE KEYING**

DIMENSIONS ARE IN:		INCH [MM]		<b>APPROVALS</b> DRAWN BAL 10/24/2000 CHECKED DJD 10/24/2000 MFG APPRV CHB 10/24/2000 QC APPRV RPO 10/24/2000 ENG APPRV BAL 10/24/2000		ANDERSON POWER PRODUCTS <b>TITLE</b> 120A DUAL POLE SPRING AND HOUSING	
UNLESS OTHERWISE STATED							
TOLERANCES:				MATERIAL: SPRINGS-STAINLESS STEEL HOUSINGS-SEE TABLE			
DECIMALS (INCH)		DECIMALS (MM)					
.XX ± .02		.X ± .5		±2°		SIZE A DWG NO. 114283S1 SCALE NONE CADFILE 01310 REV. 6 SHEET 2 OF 2	
SURFACE FINISH:							
MACHINED		128µin [3.2µ]		-CAD GENERATED DRAWING- DO NOT MANUALLY UPDATE DO NOT SCALE			
MOLDED		64µin [1.6µ]					
FINISH:							

REV.	DESCRIPTION	APPRV	DATE
-	See Sheet 1	-	-
REVISIONS			