

THE INFORMATION CONTAINED IN THIS DRAWING IS THE SOLE PROPERTY OF ANDERSON POWER PRODUCTS. ANY REPRODUCTION IN PART OR WHOLE WITHOUT THE WRITTEN PERMISSION OF ANDERSON POWER PRODUCTS IS PROHIBITED.

REV.	DESCRIPTION OF CHANGES	BY:	DATE
------	------------------------	-----	------

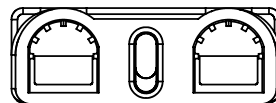

MATED PAIR

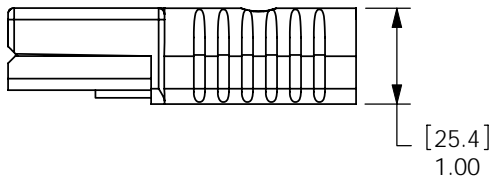
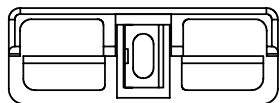
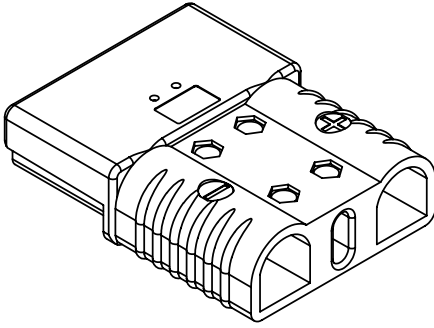
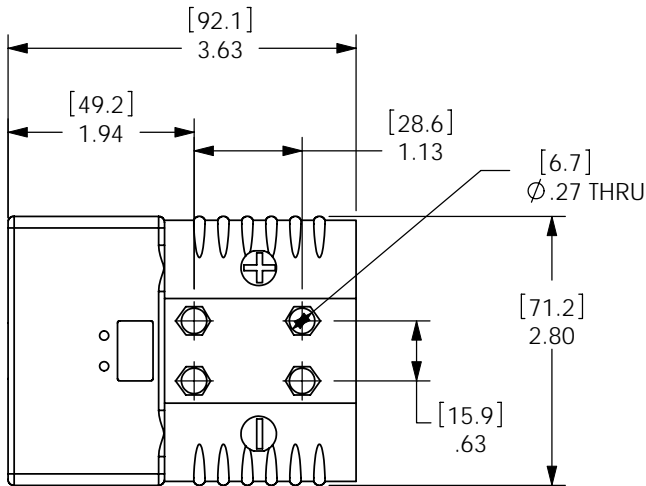
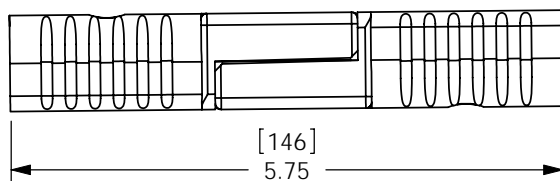

COMPLIES WITH EN1175-1 (FORMERLY EEC86/663 DIRECTIVE)

- NOTES:
1. SPRING/HOUSING ASSEMBLIES ARE UL RECOGNIZED PER FILE E26226, CSA CERTIFIED PER LR25154, AND TUV CERTIFICATION NO. R0097579.05 TO DIN VDE 0117.
 2. HOUSINGS ARE KEYED TO ONLY ALLOW MATING WITH THE SAME COLOR HOUSING
 3. FOR ASSEMBLY INSTRUCTIONS SEE DOCUMENT 1S6217
 4. HOUSINGS ASSEMBLIES ACCOMODATE ANDERSON CONTACTS FOR WIRE RANGE FROM 40 AMP TO 160 AMP ON 35 SQ. MM (#10 TO #2AWG).
 5. MATERIAL:
HOUSINGS- PBT, UL94V0
SPRING- STAINLESS STEEL
 6. OPTIONAL AUXILIARY CONTACT KIT AVAILABLE

ITEM NO.	PART OR IDENTIFYING NO.	NOMENCLATURE OR DESCRIPTION	MATERIAL SPECIFICATION	QTY REQD
COPYRIGHT 1999 ANDERSON POWER PRODUCTS. ALL RIGHTS RESERVED. UNAUTHORIZED REPRODUCTION HEREBY PROHIBITED.				
DIMENSIONS ARE IN INCHES DIMENSIONS IN PARENTHESSES () ARE IN MILLIMETERS		CAD GENERATED DRAWING, DO NOT MANUALLY UPDATE	ANDERSON POWER PRODUCTS	
TOLERANCES ARE: 2PL- ±.02 [±.5]		APPROVALS	DATE	SBE160 HOUSING AND SPRING ASSEMBLY OUTLING DRAWING
MATERIALS: SEE NOTES		DRAWN	CMS 3/15/99	
FINISH *****		CHECKED	DJD 3/15/99	
DO NOT SCALE DRAWING		RESP ENG	UFN 4/13/99	
NEXT ASSY	USED ON	MFG ENG	CHB 4/13/99	SIZE A
APPLICATION		QUAL ENG	DJM 4/13/99	SPECIFICATION: 114127S1
			SCALE	REV. 0
				CADFILES/00997
				SHEET 1 OF 1