

THE INFORMATION CONTAINED IN THIS DRAWING IS THE SOLE PROPERTY OF ANDERSON POWER PRODUCTS. ANY REPRODUCTION IN PART OR WHOLE WITHOUT THE WRITTEN PERMISSION OF ANDERSON POWER PRODUCTS IS PROHIBITED.

Copyright 2010

ANDERSON POWER PRODUCTS RESERVES THE RIGHT TO ALTER PRODUCT TYPES, THEIR TECHNICAL DATA, DIMENSION, STYLE AND ACCESSORIES WITHOUT PRIOR NOTIFICATION.

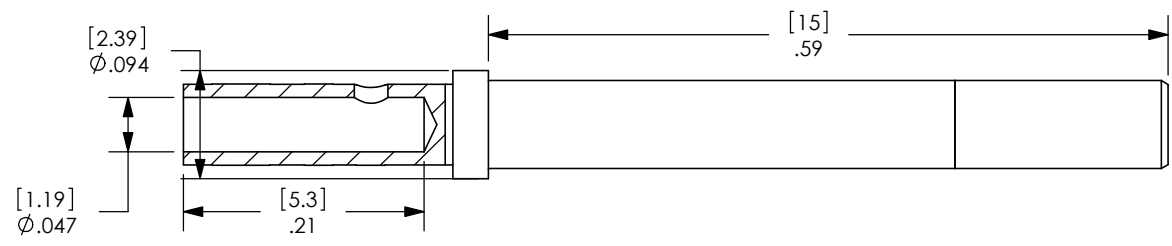
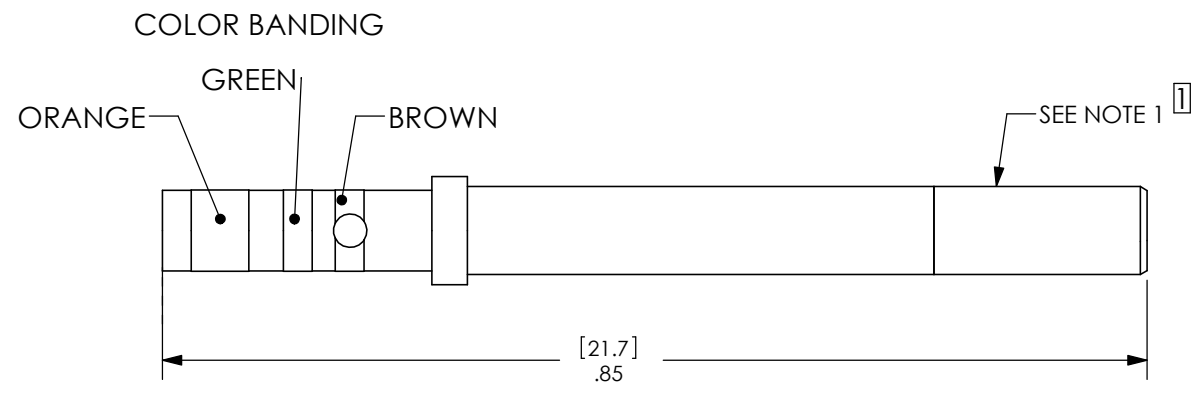

APP P/N: 4802G3-BK

- NOTES:
1. MATERIAL: COPPER ALLOY (MAY INCLUDE STAINLESS STEEL HOOD)
 2. FINISH:
 - A. SOCKET INSERT: GOLD PLATE
 - B. CONTACT BODY: GOLD OVER NICKEL PLATE
 3. FOR USE AS SIGNAL CONTACT IN SPEC PAK

DIMENSIONS ARE IN: INCH[MM]		APPROVALS		ANDERSON POWER PRODUCTS		
UNLESS OTHERWISE STATED		DRAWN	CMS	12/23/10	TITLE #20-24 AWG CRIMP SOCKET FOR 4-POLE SIGNAL CONNECTOR FOR SPEC PAK	
TOLERANCES:		CHECKED	LLD	12/23/10		
DECIMALS (INCH)	DECIMALS (MM)	ANGLES	MFG APP	CHB		12/23/10
.XX ± .015	X ± .1	± 5°	QC APP	UFN		1/3/11
.XXX ± .005	.XX ± .05		ENG APP	BD	1/3/11	
SURFACE FINISH:		MATERIAL:		SIZE		
MACHINED 128 [3.2] ✓		SEE NOTES		A/A4		
MOLDED 64 [1.6] ✓		FINISH:		DWG NO.		
		SEE NOTES		114949S1		
3rd ANGLE PROJECTION		-CAD GENERATED DRAWING- DO NOT MANUALLY UPDATE DO NOT SCALE		SCALE		
				6:1		
				CADFILE		
				03364		
				SHEET		
				1 OF 1		

1	ECRN 14899	CMS	5/4/11
REV.	DESCRIPTION	APPRV	DATE
REVISIONS			