

THE INFORMATION CONTAINED IN THIS DRAWING IS THE SOLE PROPERTY OF ANDERSON POWER PRODUCTS. ANY REPRODUCTION IN PART OR WHOLE WITHOUT THE WRITTEN PERMISSION OF ANDERSON POWER PRODUCTS IS PROHIBITED.

Copyright 2011

ANDERSON POWER PRODUCTS RESERVES THE RIGHT TO ALTER PRODUCT TYPES, THEIR TECHNICAL DATA, DIMENSION, STYLE AND ACCESSORIES WITHOUT PRIOR NOTIFICATION.

CRIMP BARREL FLARE VARIES PER CONTACT

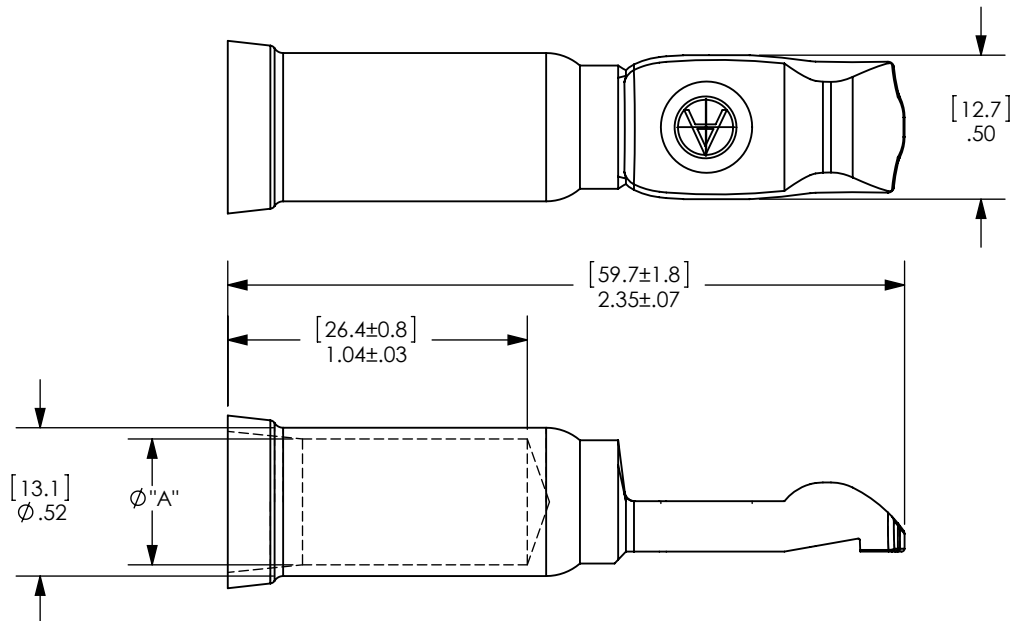
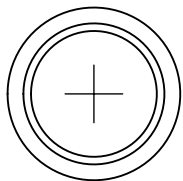
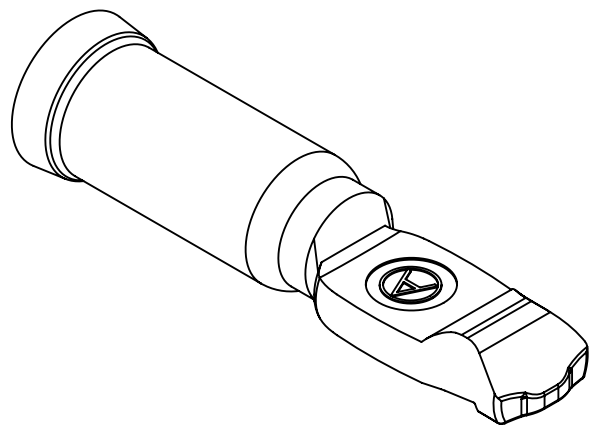

øA

CAT. NO.	WIRE SIZE	INCH	MM
1347	#1 AWG	0.39	9.9
1383	#2 AWG	0.35	8.9
1384	#4 AWG	0.30	7.6
1382	1/0	0.44	11.2

REV.	DESCRIPTION	APPRV	DATE
3	ECRN-15344 ADDED NOTE	TWE	2/22/2013
2	ECRN-15342 ADDED CAT.#1382 TO TABLE	TWE	2/21/13
1	ECRN-15003 FIXED DWG # CONFLICT	JHN	10/27/2011

REVISIONS

DIMENSIONS ARE IN:	INCH [MM]	APPROVALS		 ANDERSON POWER PRODUCTS	
UNLESS OTHERWISE STATED		DRAWN	TWE		4/28/2011
TOLERANCES:		CHECKED	LLD		4/28/2011
DECIMALS (INCH) .XX ±.02		MFG APPRV			CHB
DECIMALS (MM) .X ±.5		QC APPRV		UFN	
ANGLES ±2°		ENG APPRV		CMS	
SURFACE FINISH:		SIZE	A	DWG NO.	113878S1
MACHINED 128µin [3.2µ]		SCALE	NONE	CADFILE	01065
MOLDED 64µin [1.6µ]		SHEET	1 OF 1		
MATERIAL: COPPER ALLOY		-CAD GENERATED DRAWING- DO NOT MANUALLY UPDATE DO NOT SCALE		REV.	3
FINISH: SILVER PLATE					
 <small>3rd ANGLE PROJECTION</small>					