

THE INFORMATION CONTAINED IN THIS DRAWING IS THE SOLE PROPERTY OF ANDERSON POWER PRODUCTS. ANY REPRODUCTION IN PART OR WHOLE WITHOUT THE WRITTEN PERMISSION OF ANDERSON POWER PRODUCTS IS PROHIBITED.

**Copyright 2005**

ANDERSON POWER PRODUCTS RESERVES THE RIGHT TO ALTER PRODUCT TYPES, THEIR TECHNICAL DATA, DIMENSION, STYLE AND ACCESSORIES WITHOUT PRIOR NOTIFICATION.

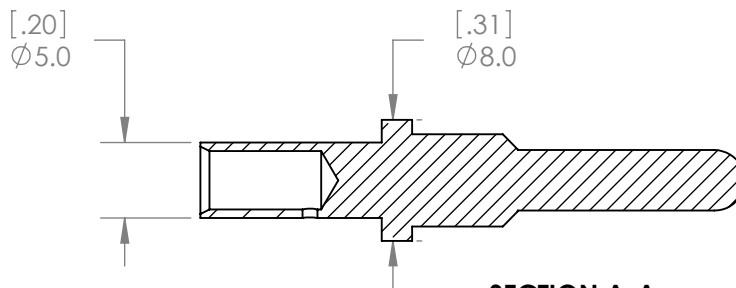
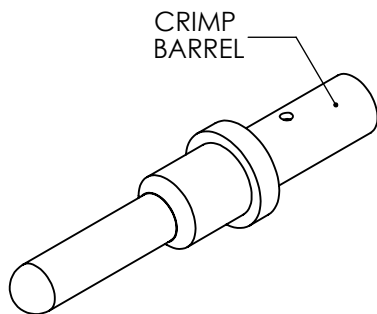
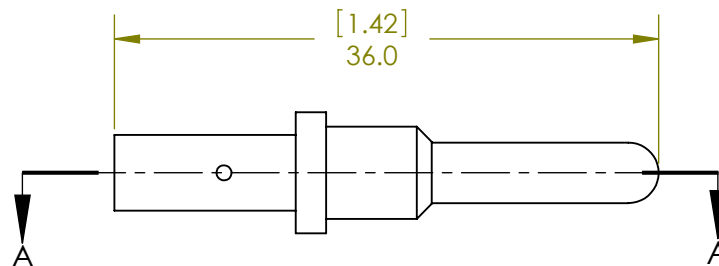
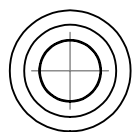

**SECTION A-A**

REV.	DESCRIPTION	APPRV	DATE
2	ECRN-15153 CORRECTED TITLE BLOCK	TWE	5/31/2012
1	ECRN-14308 ADD E160-30 NOTE	AMS	8/25/08
REVISIONS			

DIMENSIONS ARE IN: MM [INCH]		<i>APPROVALS</i>		<b>ANDERSON POWER PRODUCTS</b>
UNLESS OTHERWISE STATED		DRAWN	AMP 5/11/2005	
TOLERANCES:		CHECKED	DJD 5/11/2005	TITLE
DECIMALS (INCH)	DECIMALS (MM)	ANGLES		SALES OUTLINE EBC DIN
.XX ± .02	.X ± .5	±2°		AUX. PIN CONTACT CAT.
SURFACE FINISH:		MFG APPRV	CHB 5/10/2005	NO. 160-12 (6MM WIRE)
MACHINED	3.2µ [128µin]	QC APPRV	UFN 5/10/2005	**SUPERCEDES CAT. NO.
MOLDED	1.6µ [64µin]	ENG APPRV	DAM 5/10/2005	E160-30**
MATERIAL: COPPER ALLOY		SIZE	A	DWG NO.
FINISH: SILVER PLATE		SCALE	NONE	160-12S1
		-CAD GENERATED DRAWING- DO NOT MANUALLY UPDATE DO NOT SCALE		CADFILE
				02313
				SHEET
				1 OF 1